



Hancock County Herb Society
Grant Request
August 2019

Greenfield Indiana is the birthplace of the beloved poet, James Whitcomb Riley. With well over 1700 visitors a year to the home and museum, the gardens situated between the two buildings, is constantly on display.

These gardens should showcase what our city represents—a bit of history (Pioneer Bed) beauty (Butterfly Bed) and innovation (Pixie bed).

With the completion of the new complex, Elizabeth Ann's kitchen, there will be opportunity for companies and private citizens to rent this space.

The Riley Gardens are situated right in the middle of all of these buildings and is one of the first places a visitor may visit.

An irrigation system will greatly enhance this public space and make it much easier to care for the gardens.



Hancock County Tourism Commission
Grant Application
Hancock County Tourism & Visitor Center Office 119 W. North St., Greenfield, IN 46140
317-477-8687 ♦ info@visitinhancock.org ♦ www.visitinhancock.org

Company, Business or Organization Name Applying for the Grant:
Hancock County Herb Society

Contact Person and Title: Carolyn Swinford

Mailing Address: 1758 W. 400 N.

City: Greenfield State: IN. Zip: 46140

Preferred Phone Number: 317 326-2274 Alternate Number: _____

Email: cjswinford@gmail.com

Date of Incorporation: 1999

Federal Tax ID Number (if applicable) 91-2095936

Are you a 501c3 Not for Profit? yes If you are not, how are you considered a Not for Profit? _____

Tax Exempt Number: state # 0120839598

Please List Board of Directors, Committee or Project Members (you may attach a separate sheet with a list of all board members if needed):

Deborah Smith Kathy Locke
Judy Laird

Request Information

Describe the project need or event: An irrigation system is needed for the re-established Riley Gardens.

If the need is for an event, what is your estimated attendance? _____

How will the funding of this request increase tourism or impact other Hancock County businesses in a positive manner? See Attached memo



Hancock County Tourism Commission
Grant Application

Hancock County Tourism & Visitor Center Office 119 W. North St., Greenfield, IN 46140
317-477-8687 ♦ info@visitinhancock.org ♦ www.visitinhancock.org

How are you planning on engaging the county hotel industry in your event or project?

Does not Apply.

How do you plan to measure the tourism impact on visitors with this project or event?

Does not Apply.

Tourism Support Budget

What is the total amount that you are requesting the Tourism Commission to support?

\$3,100 - \$3,600

Please provide a breakdown of the Tourism Support Budget for your event. You may submit separate documents.

Project Needs Description: Watering system for Riley Home gardens.
(i.e. advertising, project support, studies or plans, operating expenses)

\$3100-3600 irrigation installation

\$ _____

\$ _____

\$ _____

Please attach an overall budget for your ENTIRE event or project that includes the Tourism Support Budget as well as the other areas of your budget that are not to be supported by Tourism. Please show how your own organization is supporting this project, and how other organizations, sponsors, or other grants are fulfilling the need for this event or project.

What funding, if any, is being sought from other organizations for this project? _____

(When possible, the Hancock County Tourism Commission suggests that local companies or contractors be utilized when assisting with this project)



Hancock County Tourism Commission
Grant Application

Hancock County Tourism & Visitor Center Office 119 W. North St., Greenfield, IN 46140
317-477-8687 ♦ info@visitinhancock.org ♦ www.visitinhancock.org

Have you previously requested or been granted funds by the Hancock County Tourism Commission? If so, when and for what purpose were those funds used?

yes, 11-15-11, to have new rose arbor built.

Timing

When are the funds needed for this project? We have bids from irrigation companies + we can start immediately.

If this is a long term project, is there anyway that funds could be split up over time, with partial payment now, and partial payment at a later date? If yes, how are you proposing this split to happen?

When will the event be completed or the project finished? by Fall of 2019.

You will need to submit a follow up Final Grant Report Sixty days after the completion of this project or event. On what date, will the Tourism Commission be expecting your Final Grant Report along with all of the receipts detailing the expenditures for the Tourism Support Budget listed above? within 60 days of project completion

✓ **Signature**

I hereby submit this application and supportive documents for the proposed request. I have read and understand that I must comply with the Grant Guidelines attached. I understand that if the funded request is approved, the printed and or broadcast material must indicate that **a source of the funding was via the Hancock County Tourism and Visitor Center.**

✓ Applicant Signature: Carolyn Swinford Date: 8/26/19

Title: President of HCHS.

Company or Business Name: Hancock Co. Herb Society

If approved; what name should be listed on the check? Carolyn Swinford

How would you like to receive the check? Circle one

Pick up at Visitor Center / Mail to address on application / Mail to address below.

Mail to: _____



Hancock County Tourism Commission
Grant Application

Hancock County Tourism & Visitor Center Office 119 W. North St., Greenfield, IN 46140
317-477-8687 ♦ info@visitinhancock.org ♦ www.visitinhancock.org

FOR TOURISM COMMISSION USE ONLY

Hancock County Tourism Commission Approval: Yes or No

Amount Approved: _____

Check #: _____ Date: _____

First Signature: _____ Date: _____

Second Signature: _____ Date: _____

Final Grant Report Received? Yes or No

When: _____ Complete? _____

Submitted to the Board for Review: _____

Returned Funds? Yes or No If yes, amount: _____

Notes:

Riley Gardens Budget

Soil amendment:

Topsoil (8 @ \$8 ea.)	\$ 64.00
Peat or other compost (8 @ \$10 ea.)	\$ 80.00
Fertilizer (3 @ \$10 ea.)	\$ 30.00

Plant materials:

Pixie garden	\$ 100.00
Pioneer garden	\$ 200.00
Butterfly garden	\$ 100.00

Signage: (replacement of lost or damaged signs only, may not be needed)

Plant markers	\$ 30.00
Garden identification plaques	\$ 200.00

Mulch:

Hardwood mulch (3 cu ft @ \$35 ea.)	\$ 105.00
-------------------------------------	-----------

Irrigation System: (requesting grant)

2 new beds, 2 existing beds, west of Riley Museum	\$ 3,100.00
---	-------------

\$ 4,009.00

PROPOSAL

S&S Irrigation, Inc.
(317)549-0627

08/11/19
service address
James Whitcomb Riley Museum
250 W Main St
Greenfield IN 46140

4536

Total Amount \$3,100.00

Res. (317)462-2225 Judy

Cell (317)386-1027 Debora

Description	Quantity	Unit Price	Amount
Installation of Lawn Sprinkler System			
Rain Bird 12" Spray Head	19 Each		3,100.00
Rain Switch (wireless)	1 Each		
Water Tap Installation	1 Each		

System will cover the 4 landscape bed areas as per our meeting and the attached drawing.. Price includes a water stub for the water feature.

Note: Owner must provide 3" sleeves under concrete that has not yet been poured.

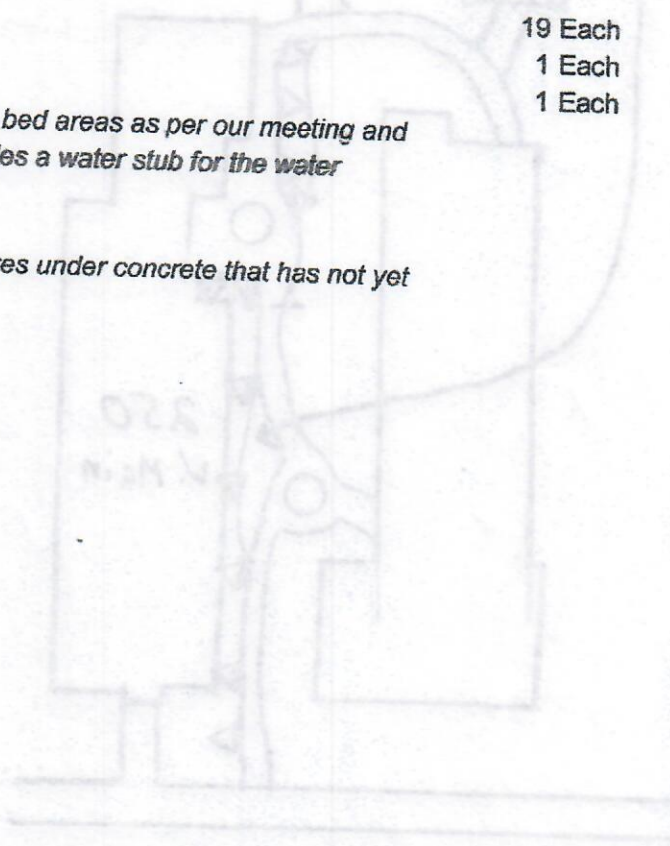

S&S Irrigation, Inc.
1924 N Meridian Rd
Greenfield, IN 46140

James Whitcomb Riley Museum
250 W Main St
Greenfield IN 46140

S&S Irrigation, Inc.
1924 N Meridian Rd
Greenfield, IN 46140

ACCEPTANCE OF PROPOSAL

The above prices, specifications and conditions are satisfactory and are hereby accepted. You are authorized to do the work as specified. Payment will be made as outlined above.

Date of Acceptance: _____

Printed Name: _____

Signature: _____

Job # 51196

Customer # 4536



TOTAL AMOUNT

\$3,100.00

Printed 08/11/19

All material is guaranteed to be as specified. All work to be completed in a workmanlike manner according to standard practices. Any alteration or deviation from above specifications involving extra costs will be executed only upon written orders, and will become an extra charge over and above the estimate. All agreements contingent upon strikes, accidents or delays beyond our control. Owner to carry fire, tornado, and other necessary insurance. Our workers are fully covered by Workmen's Compensation insurance.

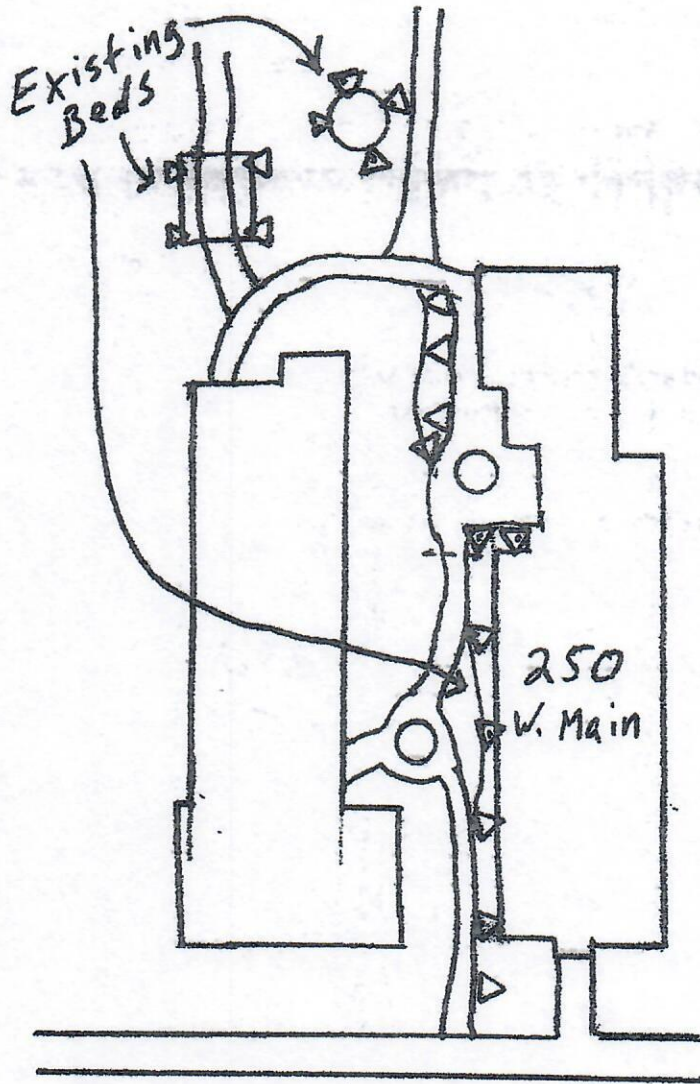

No Scale

▽ Rain Bird 1812

S&S IRRIGATION, INC.
1924 N MERIDIAN ROAD
GREENFIELD, IN 46140
(317) 549-8527

THE IRRIGATION MEDIC, LLC

QUOTE - Irrigation System

DATE: 08/02/2019

CUSTOMER: Riley Museum (Judy Laird)

ADDRESS: 244 W. Main St.

CITY/ZIP: Greenfield Indiana 46140

PHONE: 317-586-1027

NUMBER OF ZONES: 3
12

SPRAY HEADS: 9 to

ROTOR HEADS: 0

MP ROTOR HEADS: 7

TOTAL ESTIMATED COST: \$3600.00

*Prices good for 14 days

~SELF-DRAINING IRRIGATION SYSTEM

~RAIN SENSOR

~CUSTOM DESIGN BASED ON NEEDS (flower beds, gardens, landscaping)

~5-YEAR WARRANTY ON PARTS

~1-YEAR WARRANTY ON LABOR

Installation provided by The Irrigation Medic, LLC. An IDEM certified irrigation company. Please call T.i.m. Kwiatkowski 317-989-4362 with any questions you may have or to schedule work to be performed.